

Heat exchanger K1NPE to K4NPE

Technical data

Material

Material: 1.4541

Passivated and electropolished

Baffle made of Teflon in the B circuit



Connectors

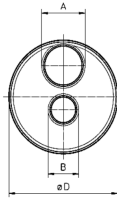

circuit A

K1N – K3N male thread 1"

K4N – male thread 1 ¼"

circuit B

Male thread ¾"

Operation limits

Maximum temperature +250 °C

Minimal temperature -50 °C

Maximum working pressure circuit A 15 bar

Maximum working pressure circuit B 25 bar

Heat exchanger K1NPE to K4NPE

Dimension

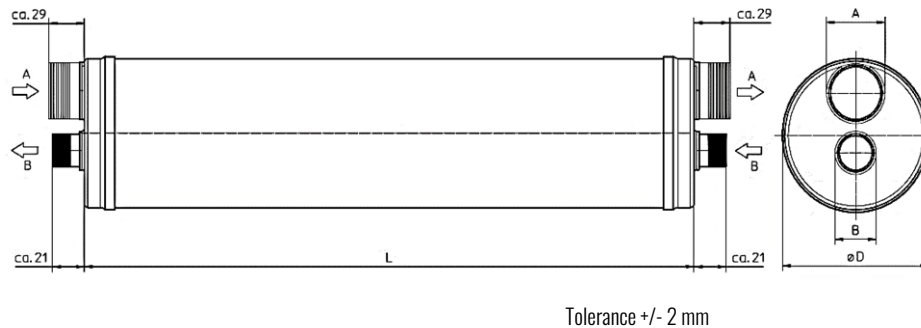

Dimensions and weights K1N PE

Diameter D = 102 mm	Length L = 275 mm
Empty weight: 5,0 kg	
Volume A circuit:	0,6 Liter
Volume B circuit:	0,8 Liter
Heat exchanger surface:	0,35 m ²

Dimensions and weights K2N PE

Diameter D = 102 mm	Length L = 395 mm
Empty weight: 7,5 kg	
Volume A circuit:	0,76 Liter
Volume B circuit:	1,2 Liter
Heat exchanger surface:	0,54 m ²

Dimensions and weights K3N PE

Diameter D = 102 mm	Length L = 515 mm
Empty weight: 10,0 kg	
Volume A circuit:	0,93 Liter
Volume B circuit:	1,6 Liter
Heat exchanger surface:	0,73 m ²

Dimensions and weights K4N PE

Diameter D = 124 mm	Length L = 515 mm
Empty weight: 16,0 kg	
Volume A circuit:	1,56 Liter
Volume B circuit:	2,4 Liter
Heat exchanger surface:	1,4 m ²